

How To

# CREATE QUILLED CHRISTMAS CARDS



Get Started

## WHAT YOU'LL NEED

**CR650**  
Quilling Starter Pack



1

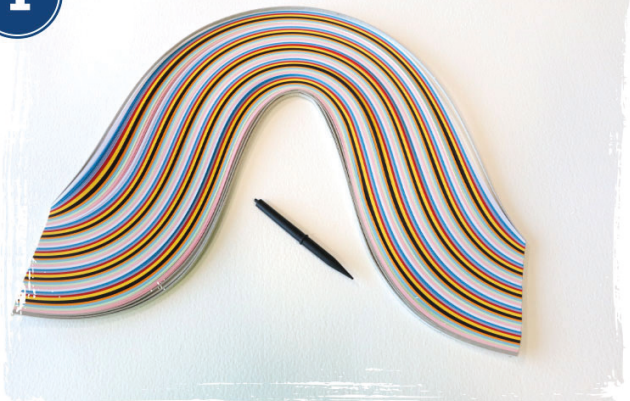

Prepare your workspace. You will need the quilling starter pack.

2

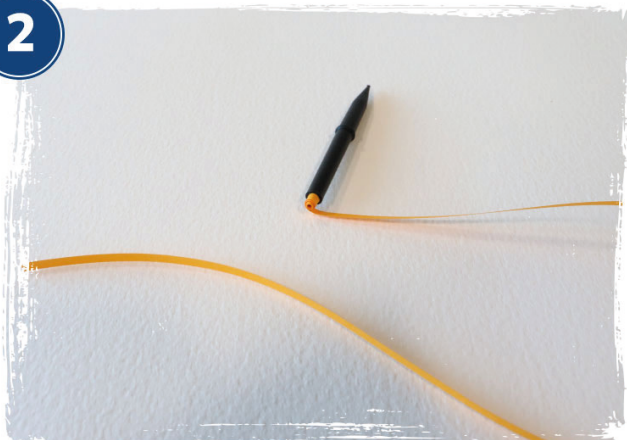

Take a paper strip and slot it into the end of the quilling tool. Start coiling the strip tightly with your fingers ensuring the paper coil doesn't unravel.

3

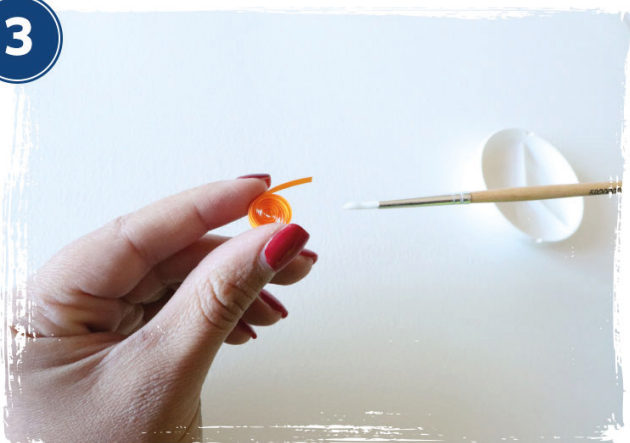

Once you have reached the end of the strip carefully remove it from the tool, and very gently allow the strip to unwind to create a loose coil. Use some glue to fix it in place.

4



After fixing, allow the glue to dry and you will end up with a loosely closed coil.

5

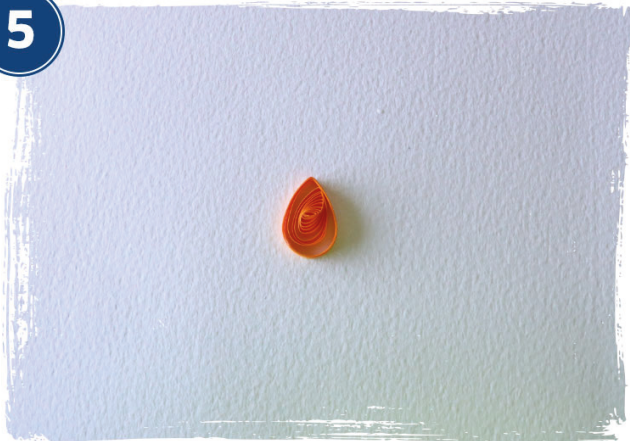

Pinch one end of the coil to create a teardrop shape.

6



Using some glue, stick your teardrop shape coil to your card. Here we have used a marker pen to create a Christmas lights design with quilled bulbs.